

NO	QTY	PART NO	DESCRIPTION	REPAIR KIT
1	1	00107000	HANDLE, VALVE, STRAIGHT	
2	1	21410004	BHCS, 10-32 x 3/8, ALY	
3	1	21430000	WASHER	
4	1	21430017	WASHER	X
5	1	21440015	SHSS, OVAL POINT	
6	1	23002011	RETAINING RING, ROUND, EXT	X
7	1	23012008	RETAINING RING, ROUND, INTL	X
8	1	23350057	SPRING, COMPRESSION	
9	1	23521018	PIN, GROOVE, TYPE H, 3/16, 1/2 LONG	
10	3	30601166	PLUG, SOCH, SAE 6	
11	1	30719706	COVER, DUST, OD, SAE 6	
12	1	30772766	COUPLING, OD, SAE 6, MALE	
13	1	30871966	ADAPTER, ACC, SAE 6 - G1/4	
14	1	35349056	ROD, RELEASE	X
15	1	35349057	RELEASE GUIDE	
16	1	35349089	PLUG, EXPANSION, 7/16	X
17	1	39000037	O-RING, (-906)	X
18	2	39010040	SEAL, VALVE, BALL	X
19	1	39010042	BU RING, (-014)	X
20	1	49011606	ASSY, ACC, 62 CC, 17 BAR, SAE 6	
21	1	70040772	ASSY, ADAPTER/FILTER, PD, 25 MICRON	
22	1	72212146	GAUGE, PRESS, HYDR, 3000 PSI	
23	1	87010190	WASHER, LIMIT, VALVE, BALL	
24	1	87010191	SPINDLE, CONTROL, VALVE, BALL	X
25	1	87010192	BALL, CONTROL, DIRECTIONAL	X
26	2	87010193	SPACER, SPINDLE, STEEL, VALVE, BALL	X
N/A	N/A	62560000	KIT, REPAIR, PALLET DECOUPLER	NOTED

NOTE:
 1. APPLY LUBRICANT TO ALL SEALS PRIOR TO INSTALLATION. DO NOT USE SILICON TYPE LUBRICANTS.
 2. SET THE OVER-PRESSURE RELIEF VALVE AT 415 BAR AND THEN INSTALL THE EXPANSION PLUG.

TORQUE TO 35 Nm

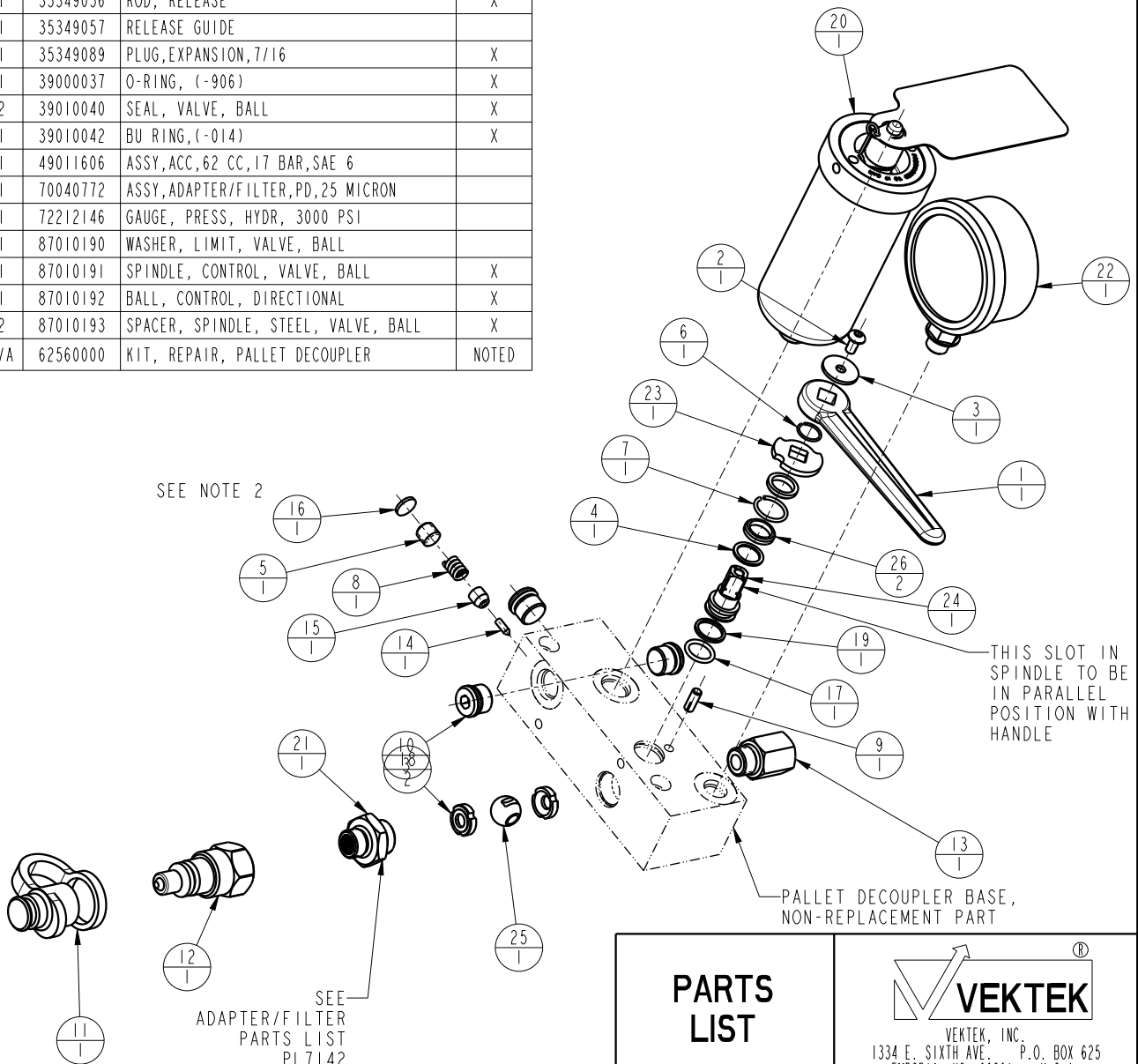

PARTS LIST



VEKTEK, INC.
 1334 E. SIXTH AVE. P.O. BOX 625
 EMPORIA, KS. 66801 U.S.A.

ASSEMBLIES AFFECTED
 45-6001-03

PARTS LIST, ASSY, PD, VERT, 17 BAR

SIZE A MPL5604

REV B

B	3876	RELEASE	JDW	10/05/25
REV	IN ACCORDANCE WITH ECN	EFFECTIVE DATE	REVISED BY	DATE
DRW BY:	MJUST	DRAWING STATUS: Released		
DATE:	08/02/19	PRODUCTION APPROVED FOR RELEASED STATUS ONLY		